

Allflex Link Stick Reader

Quick Start Up Guide

The Allflex Link stick reader is a high-performance mobile device for fast, high-volume electronic identification (EID) tag reading aimed at the livestock industry. It provides a durable and reliable solution for tracking and monitoring livestock, enabling farmers to improve efficiency and productivity in their operations. It allows pairing monitoring tags (NFC) and EID tags (RFID). By accurately tracking individual animals, farmers can monitor their behavior, well-being, and productivity, enabling them to make data-driven decisions to improve their operations.



What is in the Box

Power Plugs Adaptors
(EU, US, AU, UK)

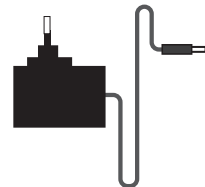

Y-Cable (USB / Charge)

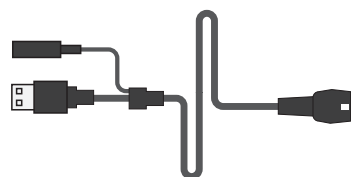

Allflex Link Reader device



Introducing Allflex Connect - a universal mobile APP to connect your EID readers with an on-farm management platform, external identification systems, and the Allflex cloud.

With Allflex Connect, you can create and edit customized animal cards and lists, share records with your herd management system, upload data to the cloud for actionable insights, connect your reader to your mobile via Bluetooth, and keep your readers up to date with regular firmware updates.

Downloading the App and pairing it with your reader before first use is recommended. To download, please visit Google Play or the Apple Store.



Getting Started

Battery Charge

The device should be fully charged before the first use. To charge please use the provided Y-Cable and power adapter

- Attach the connector to the socket at the bottom of the reader
- Push the connector against the socket and turn it clockwise until locked
- To disconnect, turn the connector counterclockwise. The socket closes itself automatically after removing the plug

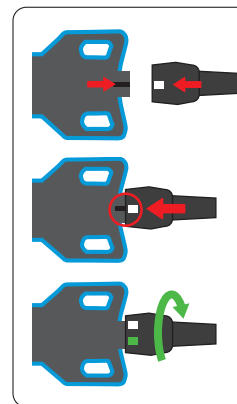

Charging is complete if no bars are flashing anymore



When charged, the battery info will show the percentage of the battery as well as a rough estimation of operating time

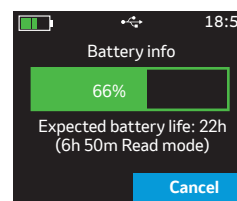

Initial Configuration

To power on the device, shortly press the green button. To power it off, press and hold the down-arrow button*.

Set Language:

The default display language will be English at first start-up. You can change the language by accessing

Menu>>Setup>>Display>>Set Language.

Navigating the options, you can then select your language preference by pressing **ENTER**.

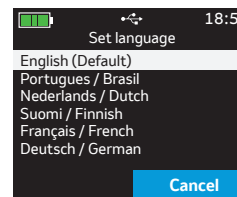

Note: It is possible to upload additional language to your reader. Contact your local distributor for further details.

Set Read mode:

By default, the reader is set to 'Single Read' - one scan click per animal. Choosing the 'Continuous mode' enables batch reading.

Note: The 'Auto' setting starts a Single Read on a short press of the ENTER key and Continuous Read mode with a long press (> one second).

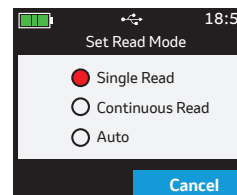

For more information visit
www.allflex.global/allflex-link-stick-reader



This product is not intended to diagnose, treat, cure, or prevent any disease in animals. For the diagnosis, treatment, cure, or prevention of disease in animals, you should consult your veterinarian. The accuracy of the data collected and presented through this product is not intended to match that of medical devices or scientific measurement devices.

Copyright© 2025 Merck & Co., Inc., Rahway, NJ, USA and its affiliates. All rights reserved. AHI-Allflex-240900002



Device Properties

RGB LED
At the top of the reader, an indication of the read status of the tag

Multi-Color Status LED
Found at the tip of the reader, indicating tags read status

Blue Status LED
Used to indicate the connection status when the display is switched off

Flashing - Charging

Solid- Fully Charged

Flashing every 3 seconds - SD Card Mode

Flashing once a second - Suspend Mode (CDC)

2.4" Color Display

Easily Controlled Ergonomic Keypad
Directional keypad with ENTER key and two multi-functional soft-keys

IP67 Connector with Bayonet Socket (Self-Closing)

Display

Battery Status Indicator
Shows the approximate battery level and battery faults, such as high temperature.

Connection status
USB, Bluetooth, RS232, WiFi

Clock
Current time presented in 24H format

Perform various functions depending on the associated screen display.

Keypad

Left Soft-Key

Right Soft-Key

Power On/ENTER Key

Direction Keys
For navigation, scrolling, and character selection in input fields

**NOTE: Press the down button key for >2 seconds to switch off the device*

Quick Reading Steps

Best Orientation for EID Reading

Best Orientation for NFC Reading

SenseHub Monitoring Ear Tag

"While a reader is actively scanning for an EID tag, it creates an electromagnetic field. This is what determines a range and best orientation of a tag for a successful reading"

Flashing slowly
RF is activated, ready to read tags

Flashing fast
Tag was successfully read

Flashing fast
Tag has been read repeatedly (duplicate)

4.The ID tag will be displayed once it has been successfully read

5.A 'No Tag' message will appear on the screen if the reading fails

Assigning Tags:
1. At the home display, press the **New Group** button
2. Insert Group Name using the direction keys to navigate the letters, numbers, or symbols
3. When finished, press **close** to exit the keyboard, and confirm the name by pressing **confirm**.
4. To assign tags to the group created, enter the group and start reading.

NOTE: After 10,000 records within one group, the device will force the user to create a new group

Quick Reading Steps

Reading EID Tags + NFC:
The NFC tags are paired with the EID tags via the Join Data menu item

1. In the main menu, select Join Data

2. Select EID + NFC

3. Press **confirm** to read the EID

4. Scan the EID

5. After a successful EID scan, press **confirm** again to trigger an NFC reading

6. The reader will initiate NFC reading

7. The animal record will appear on the screen. Press **confirm** to confirm and save your record. Select New NFC to initiate an additional reading.

Note:
At the home screen, pressing the **confirm** on your keypad will initiate an independent NFC tag reading